

User Point Diaphragm Valve

Forged stainless steel body,
manually operated



Description

Series 30 manually operated diaphragm valve has a flow-optimized stainless steel body, a diaphragm, a bonnet and manual handle. The stainless steel body is available with various surface finish. The diaphragm is both a switch as well as a sealing element for the media. It is easily replaceable. The bonnet is provided for the protection of diaphragm and handle-mechanism. The upright connection flow can be continually adjusted with proper positioning of the handle. The position indicator is provided at the top of the handle. This valve is designed for zero dead leg and can be mounted to be self-draining. This allows high flow capacity and variety of applications.

Main Features

- Very useful at sampling / injection points on high purity systems
- Compact construction
- Hermetical separation of fluids from the operating mechanism by diaphragm
- Fully machined from SS 316L bar-stock – no welded components
- Zero dead leg
- Self-draining operation
- Fully Autoclavable
- Various internal surface finish available each with less than 0.40 Ra

Dimensions

User point diaphragm valve, forged stainless steel body, manually operated Body with Butt-weld End

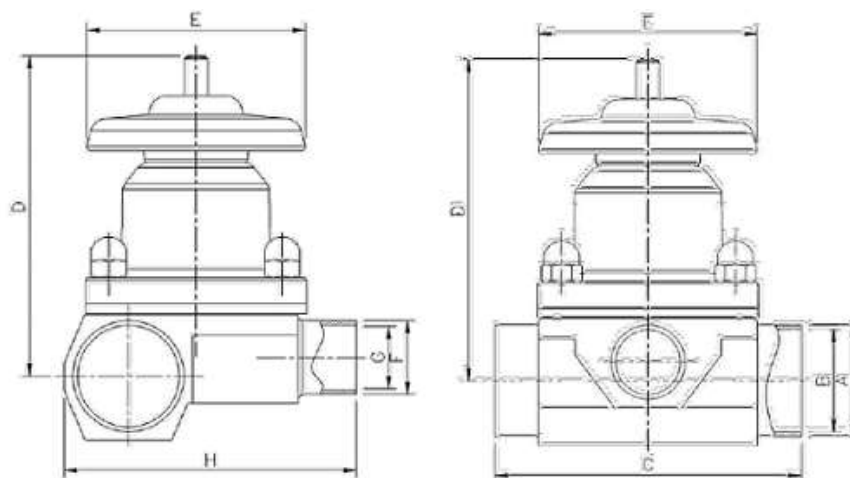

Figure 30-1 Bonnet & handle- Stainless Steel

Figure 30-1 Bonnet & handle- Stainless Steel

Main Conn. Size	Main Pipe OD	Main Pipe ID	Face to face length	Max. Valve Height From Pipe Center	Outside Diameter of Handle	Upright Conn. Size	Upright Pipe OD	Upright Pipe ID	Valve Width
	A [mm]	B [mm]	C [mm]	D [mm]	E [mm]		F [mm]	G [mm]	H [mm]
1/2"	12.70	9.40	88.0	78.8	59.5	1/2"	12.70	9.40	65.0
3/4"	19.05	15.75	88.0	81.4	59.5	1/2"	12.70	9.40	65.0
3/4"	19.05	15.75	88.0	81.4	59.5	3/4"	19.05	15.75	65.0
1"	25.40	22.10	88.0	87.8	59.5	1/2"	12.70	9.40	70.6
1"	25.40	22.10	88.0	87.8	59.5	3/4"	19.05	15.75	70.6
1"	25.40	22.10	113.0	103.5	72.0	1"	25.40	22.10	89.0
1 1/2"	38.10	34.80	88.0	94.5	59.5	1/2"	12.70	9.40	76.5
1 1/2"	38.10	34.80	88.0	94.5	59.5	3/4"	19.05	15.75	83.3
1 1/2"	38.10	34.80	113.0	112.8	72.0	1"	25.40	22.10	99.2
1 1/2"	38.10	34.80	134.9	140.9	109.5	1 1/2"	38.10	34.80	111.9
2"	50.80	47.50	88.0	99.9	59.5	1/2"	12.70	9.40	94.4
2"	50.80	47.50	88.0	99.9	59.5	3/4"	19.05	15.75	96.6
2"	50.80	47.50	113.0	120.9	72.0	1"	25.40	22.10	108.0
2"	50.80	47.50	134.9	148.5	109.5	1 1/2"	38.10	34.80	121.0
2"	50.80	47.50	134.9	145.8	109.5	2"	50.80	47.50	121.0
2 1/2"	63.50	60.20	88.0	102.3	59.5	1/2"	12.70	9.40	105.3
2 1/2"	63.50	60.20	88.0	105.8	59.5	3/4"	19.05	15.75	105.3
2 1/2"	63.50	60.20	113.0	124.6	72.0	1"	25.40	22.10	122.0
2 1/2"	63.50	60.20	134.9	152.2	109.5	1 1/2"	38.10	34.80	134.5
2 1/2"	63.50	60.20	134.9	152.2	109.5	2"	50.80	47.50	134.5
2 1/2"	63.50	60.20	159.1	162.6	152.0	2 1/2"	63.50	60.20	146.2
3"	76.20	72.90	88.0	112.6	59.5	1/2"	12.70	9.40	100.8
3"	76.20	72.90	88.0	112.6	59.5	3/4"	19.05	15.75	105.3
3"	76.20	72.90	113.0	130.9	72.0	1"	25.40	22.10	134.9
3"	76.20	72.90	134.9	158.5	109.5	1 1/2"	38.10	34.80	147.3
3"	76.20	72.90	134.9	158.5	109.5	2"	50.80	47.50	147.3
3"	76.20	72.90	159.1	168.9	152.0	2 1/2"	63.50	60.20	158.9

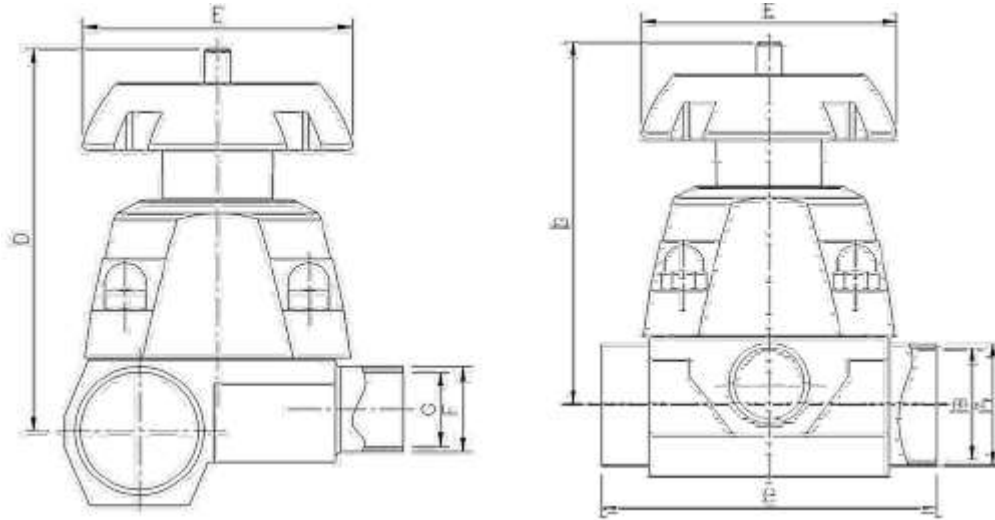

Figure 30-2 Bonnet & handle- Polyamide

Figure 30-2 Bonnet & handle- Polyamide

Main Conn. Size	Main Pipe OD	Main Pipe ID	Face to face length	Max. Valve Height From Pipe Center	Outside Diameter of Handle	Upright Conn. Size	Upright Pipe OD	Upright Pipe ID	Valve Width
	A [mm]	B [mm]	C [mm]	D [mm]	E [mm]		F [mm]	G [mm]	H [mm]
1/2"	12.70	9.40	88.0	88.8	79.0	1/2"	12.70	9.40	65.0
3/4"	19.05	15.75	88.0	91.4	79.0	1/2"	12.70	9.40	65.0
3/4"	19.05	15.75	88.0	91.4	59.5	3/4"	19.05	15.75	65.0
1"	25.40	22.10	88.0	97.8	79.0	1/2"	12.70	9.40	70.6
1"	25.40	22.10	88.0	97.8	79.0	3/4"	19.05	15.75	70.6
1"	25.40	22.10	113.0	110.8	92.0	1"	25.40	22.10	89.0
1 1/2"	38.10	34.80	88.0	104.5	79.0	1/2"	12.70	9.40	76.5
1 1/2"	38.10	34.80	88.0	104.5	79.0	3/4"	19.05	15.75	83.3
1 1/2"	38.10	34.80	113.0	120.1	92.0	1"	25.40	22.10	99.2
1 1/2"	38.10	34.80	134.9	133.3	116.5	1 1/2"	38.10	34.80	111.9
2"	50.80	47.50	88.0	109.9	79.0	1/2"	12.70	9.40	94.4
2"	50.80	47.50	88.0	109.9	59.5	3/4"	19.05	15.75	96.6
2"	50.80	47.50	113.0	128.2	92.0	1"	25.40	22.10	108.0
2"	50.80	47.50	134.9	140.9	116.5	1 1/2"	38.10	34.80	121.0
2"	50.80	47.50	134.9	138.2	116.5	2"	50.80	47.50	121.0
2 1/2"	63.50	60.20	88.0	112.3	59.5	1/2"	12.70	9.40	105.3
2 1/2"	63.50	60.20	88.0	115.8	59.5	3/4"	19.05	15.75	105.3
2 1/2"	63.50	60.20	113.0	131.9	92.0	1"	25.40	22.10	122.0
2 1/2"	63.50	60.20	134.9	144.6	109.5	1 1/2"	38.10	34.80	134.5
2 1/2"	63.50	60.20	134.9	144.6	116.5	2"	50.80	47.50	134.5
2 1/2"	63.50	60.20	159.1	170.6	149.0	2 1/2"	63.50	60.20	146.2
3"	76.20	72.90	88.0	122.6	59.5	1/2"	12.70	9.40	100.8
3"	76.20	72.90	88.0	122.6	59.5	3/4"	19.05	15.75	105.3
3"	76.20	72.90	113.0	138.2	92.0	1"	25.40	22.10	134.9
3"	76.20	72.90	134.9	150.9	109.5	1 1/2"	38.10	34.80	147.3
3"	76.20	72.90	134.9	150.9	116.5	2"	50.80	47.50	147.3
3"	76.20	72.90	159.1	176.9	149.0	2 1/2"	63.50	60.20	158.9

User point diaphragm valve, forged stainless steel body, manually operated
Body with V-band (Hygienic) Clamp Connector

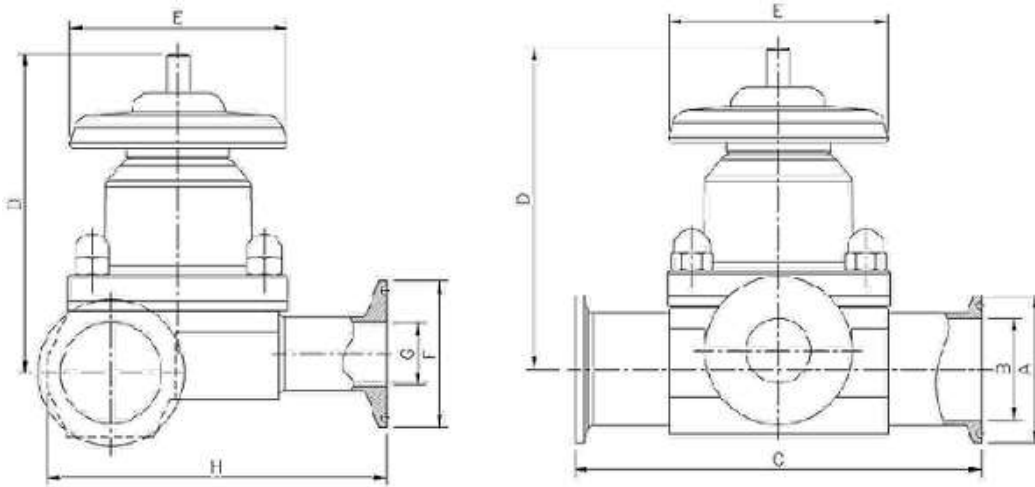

Figure 30-3 Bonnet & handle- Stainless Steel

Figure 30-3 Bonnet & handle- Stainless Steel

Main Conn. Size	Main Pipe OD	Main Pipe ID	Face to face length	Max. Valve Height From Pipe Center	Outside Diameter of Handle	Upright Conn. Size	Upright Pipe OD	Upright Pipe ID	Valve Width
	A [mm]	B [mm]	C [mm]	D [mm]	E [mm]		F [mm]	G [mm]	H [mm]
1/2"	25.00	9.40	113.4	78.8	59.5	1/2"	25.00	9.40	77.7
3/4"	25.00	15.75	113.4	81.4	59.5	1/2"	25.00	9.40	77.7
3/4"	25.00	15.75	113.4	81.4	59.5	3/4"	25.00	15.75	77.7
1"	50.40	22.10	113.4	87.8	59.5	1/2"	25.00	9.40	83.3
1"	50.40	22.10	113.4	87.8	59.5	3/4"	25.00	15.75	83.3
1"	50.40	22.10	138.4	103.5	72.0	1"	50.40	22.10	101.7
1 1/2"	50.40	34.80	113.4	94.5	59.5	1/2"	25.00	9.40	89.2
1 1/2"	50.40	34.80	113.4	94.5	59.5	3/4"	25.00	15.75	96.0
1 1/2"	50.40	34.80	138.4	112.8	72.0	1"	50.40	22.10	111.9
1 1/2"	50.40	34.80	160.3	140.9	109.5	1 1/2"	50.40	34.80	124.6
2"	63.90	47.50	113.4	99.9	59.5	1/2"	25.00	9.40	107.1
2"	63.90	47.50	113.4	99.9	59.5	3/4"	25.00	15.75	109.3
2"	63.90	47.50	138.4	120.9	72.0	1"	50.40	22.10	120.7
2"	63.90	47.50	160.3	148.5	109.5	1 1/2"	50.40	34.80	133.7
2"	63.90	47.50	160.3	145.8	109.5	2"	63.90	47.50	133.7
2 1/2"	77.40	60.20	113.4	102.3	59.5	1/2"	25.00	9.40	118.0
2 1/2"	77.40	60.20	113.4	105.8	59.5	3/4"	25.00	15.75	118.0
2 1/2"	77.40	60.20	138.4	124.6	72.0	1"	50.40	22.10	134.7
2 1/2"	77.40	60.20	160.3	152.2	109.5	1 1/2"	50.40	34.80	147.2
2 1/2"	77.40	60.20	160.3	152.2	109.5	2"	63.90	47.50	147.2
2 1/2"	77.40	60.20	184.5	162.6	152.0	2 1/2"	77.40	60.20	158.9
3"	90.90	72.90	113.4	112.6	59.5	1/2"	25.00	9.40	113.5
3"	90.90	72.90	113.4	112.6	59.5	3/4"	25.00	15.75	118.0
3"	90.90	72.90	138.4	130.9	72.0	1"	50.40	22.10	147.6
3"	90.90	72.90	160.3	158.5	109.5	1 1/2"	50.40	34.80	160.0
3"	90.90	72.90	160.3	158.5	109.5	2"	63.90	47.50	160.0
3"	90.90	72.90	184.5	168.9	152.0	2 1/2"	77.40	60.20	171.6

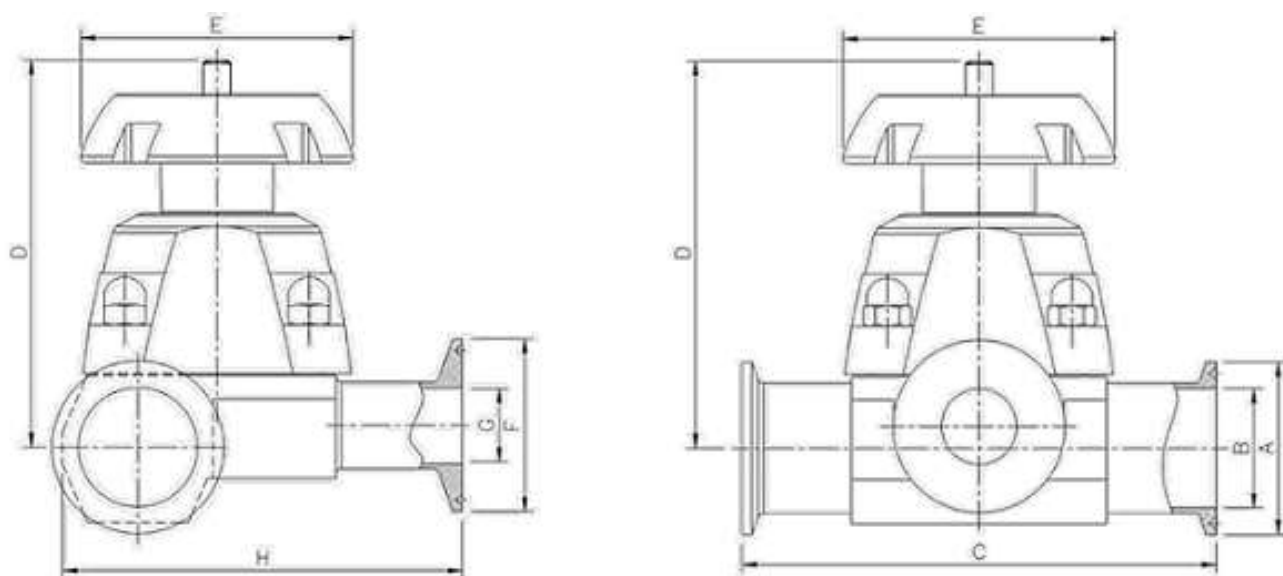

Figure 30-4 Bonnet & handle- Polyamide

Figure 30-4 Bonnet & handle- Polyamide

Main Conn. Size	Main Pipe OD	Main Pipe ID	Face to face length	Max. Valve Height From Pipe Center	Outside Diameter of Handle	Upright Conn. Size	Upright Pipe OD	Upright Pipe ID	Valve Width
	A [mm]	B [mm]	C [mm]	D [mm]	E [mm]		F [mm]	G [mm]	H [mm]
1/2"	25.00	9.40	113.4	88.8	79.0	1/2"	25.00	9.40	77.7
3/4"	25.00	15.75	113.4	91.4	79.0	1/2"	25.00	9.40	77.7
3/4"	25.00	15.75	113.4	91.4	59.5	3/4"	25.00	15.75	77.7
1"	50.40	22.10	113.4	97.8	79.0	1/2"	25.00	9.40	83.3
1"	50.40	22.10	113.4	97.8	79.0	3/4"	25.00	15.75	83.3
1"	50.40	22.10	138.4	110.8	92.0	1"	50.40	22.10	101.7
1 1/2"	50.40	34.80	113.4	104.5	79.0	1/2"	25.00	9.40	89.2
1 1/2"	50.40	34.80	113.4	104.5	79.0	3/4"	25.00	15.75	96.0
1 1/2"	50.40	34.80	138.4	120.1	92.0	1"	50.40	22.10	111.9
1 1/2"	50.40	34.80	160.3	133.3	116.5	1 1/2"	50.40	34.80	124.6
2"	63.90	47.50	113.4	109.9	79.0	1/2"	25.00	9.40	107.1
2"	63.90	47.50	113.4	109.9	59.5	3/4"	25.00	15.75	109.3
2"	63.90	47.50	138.4	128.2	92.0	1"	50.40	22.10	120.7
2"	63.90	47.50	160.3	140.9	116.5	1 1/2"	50.40	34.80	133.7
2"	63.90	47.50	160.3	138.2	116.5	2"	63.90	47.50	133.7
2 1/2"	77.40	60.20	113.4	112.3	59.5	1/2"	25.00	9.40	118.0
2 1/2"	77.40	60.20	113.4	115.8	59.5	3/4"	25.00	15.75	118.0
2 1/2"	77.40	60.20	138.4	131.9	92.0	1"	50.40	22.10	134.7
2 1/2"	77.40	60.20	160.3	144.6	109.5	1 1/2"	50.40	34.80	147.2
2 1/2"	77.40	60.20	160.3	144.6	116.5	2"	63.90	47.50	147.2
2 1/2"	77.40	60.20	184.5	170.6	149.0	2 1/2"	77.40	60.20	158.9
3"	90.90	72.90	113.4	122.6	59.5	1/2"	25.00	9.40	113.5
3"	90.90	72.90	113.4	122.6	59.5	3/4"	25.00	15.75	118.0
3"	90.90	72.90	138.4	138.2	92.0	1"	50.40	22.10	147.6
3"	90.90	72.90	160.3	150.9	109.5	1 1/2"	50.40	34.80	160.0
3"	90.90	72.90	160.3	150.9	116.5	2"	63.90	47.50	160.0
3"	90.90	72.90	184.5	176.9	149.0	2 1/2"	77.40	60.20	171.6

Notes:

1. For V-band (Hygienic) clamp connections, clamp connector will be welded to the valve body with butt-weld end. Internal finish will be provided as per customer request.
2. Dimensions and tolerances for end connection and face-to-face length are as per ASME BPE.
3. All other dimensions are approximate and subject to change without prior notice.
4. Dimensions for valves with steel bonnet and polyamide handle will be provided on request.

Technical Data

Processing medium

Neutral gases and liquids, high purity, sterile, aggressive or abrasive fluids

Temperature

Media temperature		Sterilization temperature		Ambient Temperature
EPDM	-10°C to 75°C	EPDM	Briefly up to 130°C	Up to 90°C
PTFE	-10°C to 90°C	PTFE	Briefly up to 150°C	

Valve body material

MOC – Wetted (Contact)	MOC – Non-wetted (Non- contact)
Stainless Steel 316L	Polyamide or ASTM A351 CF8 (SS 304)

End connection

V-band (Hygienic) Clamp	ASME BPE (EN ISO 1127/ISO 4200 and BS 4825 are available on request)
Butt-Weld	

Installation

Installation for self draining mounting	Tilted 10°C to 35°C to the horizontal and inclined 3°C to 5°C to the direction of flow
---	--

Data Order

M5	1/2" Mini
R5	1/2" Regular
07	3/4"
10	1"
15	1 1/2"
20	2"
25	2 1/2"
30	3"

Type of Diaphragm	
EPDM	E
PTFE	P

Certificate	
ISO 9001	9
ISO 9001 + 'CE' (PED 97/23/EC)	p ¹

Connection Type	
ASME BPE	A
BS 4825	B
EN ISO 1127 / ISO 4200	E ²

Upright conn. size	
05	1/2"
07	3/4"
10	1"
15	1 1/2"
20	2"
25	2 1/2"

Type of End Connection	
Butt Weld	B
V- Band (hygienic) Clamp	T

Surface Finish	
Mechanical Polish	M
Electro Polish	E

Bonnet & handle Material of Construction ³	
ASTM A351 GR CF8	C
Polyamide	P

Order Example	LE	30	A	10	10	E	P	P	E	T	9
Leistung											
Series #											
Conn. Type											
Conn. Size											
Upright Conn. size											
Type of diaphragm											
Bonnet											
Handle											
Surface finish											
Type of end conn.											
Certificate											

Notes:

- 'CE'-marking is applicable for valves with connection sizes 1 1/2", 2", 2 1/2" and 3" only.
- EN ISO 1127/ISO 4200 offers standards for butt-weld end connections only.
- Combination of polyamide bonnet and steel handle (LE10XXXXPCXXX) is not available.
- Valves with end connection sizes according to EN ISO 1127/ISO 4200 and BS 4825 are available on request

Contact: sales@titanresearch.ca
<https://www.titangroupsupply.com/>

[change to info@titangroupsupply.com for all](mailto:info@titangroupsupply.com)

Tel: 1-800-820-0092
 Fax: 1-416-849-0116

[change to TEL FOR ALL](tel:18008200092)

For further diaphragm valves, gaskets, compatible actuators & accessories and other products, please contact us for pricing.